

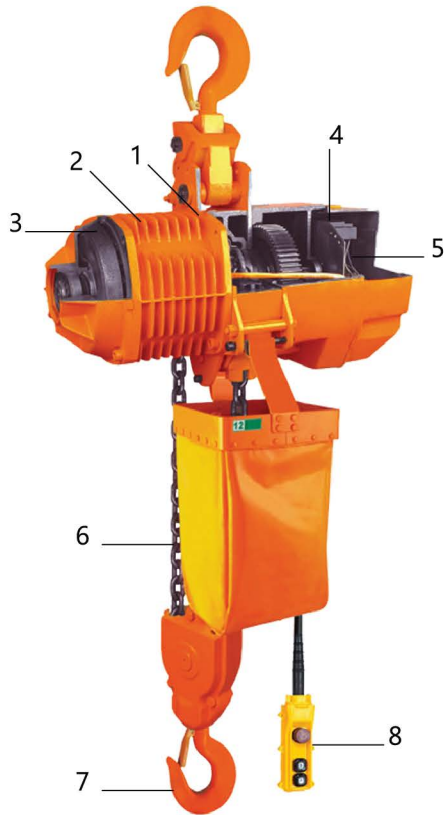

Electric Chain Hoist

Scan to download
E-Catalog





- 1 - Support frame : The loading support frame consists of two steel plates, which is extremely sturdy.
- 2 - Shell : It is made of light aluminum alloy shell, light but hard. The cooling fin is specially designed to ensure quick heat dissipation with the rate up to 40% and continuous working. The integral enclosed structure is applicable for chemical plant, electroplate factory, etc.
- 3 - Side magnetic braking device : The magnetic force generator is the latest design which allows instant brake when electric power is cut off. Thus the braking safety while loading is guaranteed.
- 4 - Reverse phase sequence protection device : It is the special electrical part which cut the control circuit in case of wiring error in the power supply.
- 5 - Transformer : The 24VAC transformer is used to prevent unexpected accidents caused by electric leakage.
- 6 - Load chain : The chain is a Japan special heat-treated alloy steel chain (FEC80). It can be safely used in poor environments such as rain, sea water and chemicals.
- 7 - Hook : It is hot forging with perfect strength that is hard to break. The operation safety of the lower hook is ensured by its 360 degrees rotation and safety latch.
- 8 - Push button switch : Waterproof push button switch is applied and come with emergency switch. It is light and durable.

Load Chain

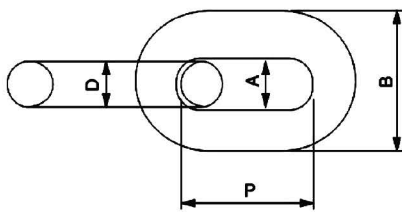

Model	Dia. D (mm)	Pitch P (mm)	Inside Width A (mm)	Outside Width B (mm)
BM0.5-01S	6.3	19.0	7.9	22.0
BM01-01S	7.1	21.0	8.9	25.0
BM02-01S	10.0	30.0	12.5	35.0
BM03-01S	11.2	34.0	14.0	39.0
BM05-02S				
BM7.5-03S				
BM10-04S				

Hook

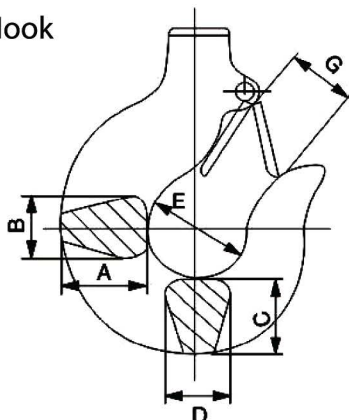

Model	A (mm)	B (mm)	C (mm)	D (mm)	E (mm)	G (mm)
BM0.5-01S	27	18	25	17	35	28
BM01-01S	34	34	30	24	42	32
BM02-01S	46	46	39	30	49	40
BM03-01S	56	56	49	34	59	48
BM05-02S	67	67	57	44	60	48
BM7.5-03S	82	55	80	48	85	80
BM10-04S						

Electric Chain Hoist

BM Series



Electric Chain Hoist with Hook - Model BM-S



Main Features

- Light aluminium alloy shell, light-weight but hard, is adopted to be easy for heat dissipation
- Reverse phase sequence protection device will cut the control circuit in case of wiring error in the power supply.
- Limit switch is installed to protect overtravelling while lifting or lowering.
- 24VAC control system is used to prevent electric leakage.
- The side magnetic brake device provides immediate braking when power fails, thus ensuring safe braking during loading.
- The chain shall adopt the Japan FEC80 ultra heat-treated alloy steel chain.

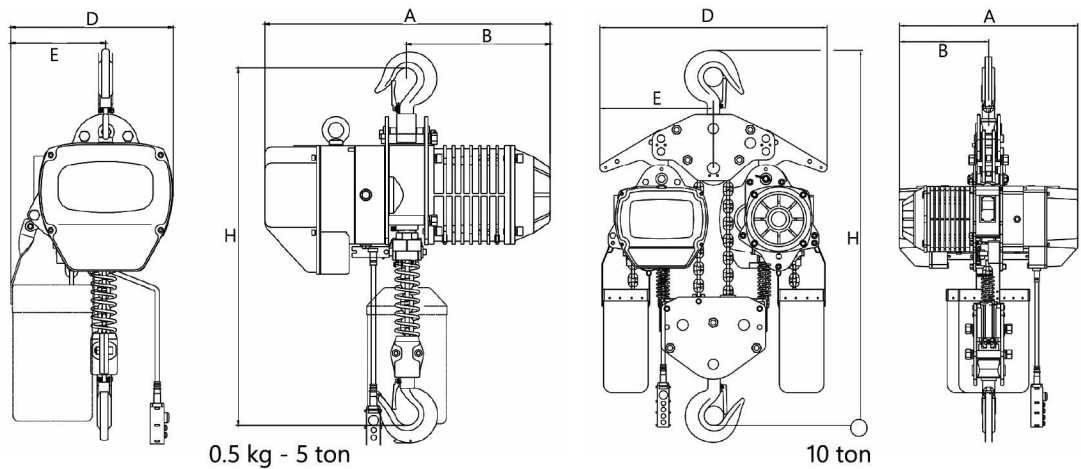

Model	Rated Load (ton)	Load Chain		Lifting Speed (m/min)	Lifting Motor (kW)	Net Weight (Lift 6 m) (kg)
		Dia. (mm)	No. of fall			
BM0.5-01S	0.5	6.3	1	7.2	0.75	42
BM01-01S	1.0	7.1		6.8	1.5	61
BM02-01S	2.0	10.0		6.6	3.0	115
BM03-01S	3.0	11.2		5.6		122
BM05-02S	5.0			2		2.8
BM7.5-03S	7.5			3	1.8	176
BM10-04S	10.0			4	2.8	2 x 3.0

Model	Rated Load (ton)	Dimension (mm)				Min. Headroom H (mm)
		A	B	D	E	
BM0.5-01S	0.5	460	230	288	178	530
BM01-01S	1.0	520	260	300	176	650
BM02-01S	2.0	615	295	430	265	800
BM03-01S	3.0	615	295	430	265	845
BM05-02S	5.0	615	295	430	325	1,030
BM7.5-03S	7.5	615	295	505	320	1,200
BM10-04S	10.0	630	315	890	445	1,400

Electric Chain Hoist with Electric Trolley - Model BM-SET



Main Features

- Light aluminium alloy shell, light-weight but hard, is adopted to be easy for heat dissipation
- Reverse phase sequence protection device will cut the control circuit in case of wiring error in the power supply.
- Limit switch is installed to protect overtravelling while lifting or lowering.
- 24VAC control system is used to prevent electric leakage.
- The side magnetic brake device provides immediate braking when power fails, thus ensuring safe braking during loading.
- The chain shall adopt the Japan FEC80 ultra heat-treated alloy steel chain.

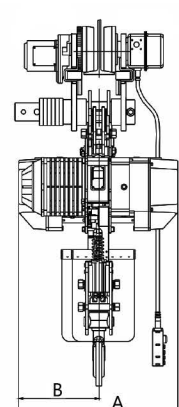
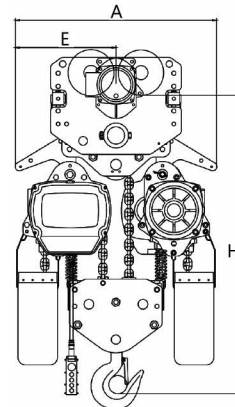
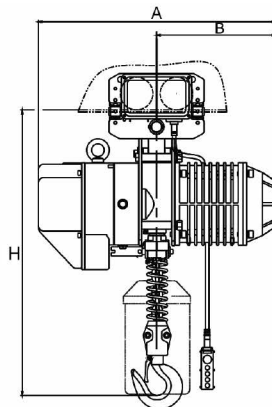
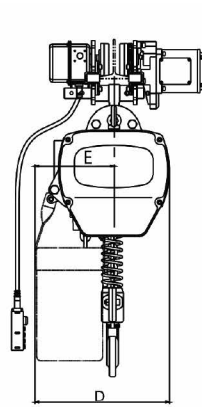
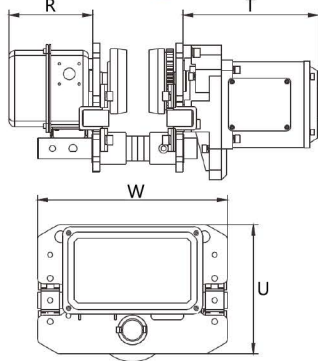

0.5 kg - 5 ton

10 ton

Model	Rated Load (ton)	Load Chain		Lifting Speed (m/min)	Lifting Motor (kW)	Traversing Speed (m/min)	Traversing Motor (kW)	Net Weight (Lift 6 m) (kg)
		Dia. (mm)	No. of fall					
BM0.5-01SET	0.5	6.3	1	7.2	0.75	21.0	0.4	86
BM01-01SET	1.0	7.1		6.8	1.5			102
BM02-01SET	2.0	10.0		6.6	3.0		0.75	163
BM03-01SET	3.0	11.2		5.6				184
BM05-02SET	5.0		2	2.8		234		
BM7.5-03SET	7.5		3	1.8		265		
BM10-04SET	10.0		4	2.8	440			

Model	Rated Load (ton)	Dimension (mm)								Beam Width (mm)	Min. Radius (mm)	Min. Headroom H (mm)
		A	B	D	E	R	T	U	W			
BM0.5-01SET	0.5	460	230	288	178	142	231	212	315	58 - 153	0.7	635
BM01-01SET	1.0	520	260	300	176	142	231	212	315	58 - 153	0.8	650
BM02-01SET	2.0	615	295	430	265	142	231	220	325	85 - 178	0.9	770
BM03-01SET	3.0	615	295	430	265	142	231	250	340	100 - 178	1.0	830
BM05-02SET	5.0	615	295	430	325	142	231	291	400	100 - 178	1.5	1,015
BM7.5-03SET	7.5	615	295	505	320	142	231	291	400	100 - 178	1.8	1,200
BM10-04SET	10.0	630	315	890	445	142	231	371	500	150 - 220	2.0	1,400