



- Electric Chain Hoist
- Electric Wire Rope Hoist
- End Carriages
- Crane Motor
- Portable Gantry Crane
- Crane Wheel Block
- Electric Chain Hoist (Ex-proof)

Scan to download  
E-Catalog





## Higher Performance & Faster

BMS electric chain hoist is manufactured with high performance, high safety, and high reliability design concept to increase a productivity and to perform the work to achieve the highest efficiency.

BMS 2-speed electric chain hoist is designed for more various hoisting applications. Fast speed makes the work more efficient. Slow speed makes the work more accurate.

## Longer service life

BMS electric chain hoist's service life is extended by approx. 20% in comparison with the conventional 2m classification for FEM rating.

It results in significantly prolonged time between service intervals and general overhauls.

This extra operating life is only offered by BMS european electric chain hoist.

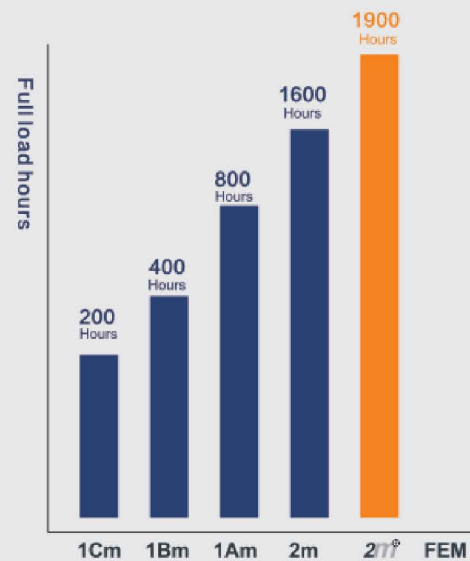

## Maintenance: Fast and Simple

All BMS electric chain hoist's main drive components, such as gear box, brake and clutch, are made by a special process to improve them more durable. For example, BMS series brake is maintenance-free for 5 years. BRIMA hoist still has a long working life with high quality even with more frequent hoisting.

Because BMS european electric chain hoist is designed with ease of service concept, it can be maintained quicker and simpler.

The chain drive is designed as a compact unit which is slid into place, so it can be replaced in a minimum of time without the need to disassemble motor or gearbox parts. Long downtime as a result of maintenance work is not required anymore.

# Electric Chain Hoist

## BMS Series



### Motor :

The BMS hoist's motor has passed all relevant authority quality certification. The motor has very high-performance but compact size and light weight. The duty factor is up to 60% (40/20). The insulation class is class F. The speed of motor can reach up to 3,000 RPM.

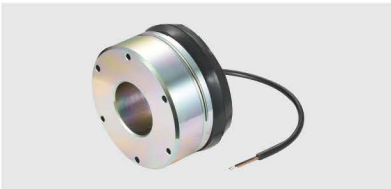

### Brake :

The lifting-hoist electromagnetic brake located at the end of transmission gear shaft is maintenance-free design, so its clearance is adjusted automatically. Its material does not contain Asbestos. The brake is completely enclosed and has high protection level to meet the requirements in harsh environment. Also, it is tested for 1 million times. The braking torque is 2 times of rated to motor torque.



### Slipping clutch :

The slipping clutch, integrated on the transmission gear shaft, protects the overload lifting. The maintenance-free design can keep the torque up to 1.52 times of safe load, and the overload torque can be adjusted.



### Reduction gear :

The reduction gear, helical gear design and lubricated in oil bath, makes high-transmission efficiency and low noise. The gears put through heat treatment process after grinding, and its teeth are also surface hardened. Its accuracy is grade 7 or higher. So, it has ultra-long life, ultra-low noise, and efficient transmission.

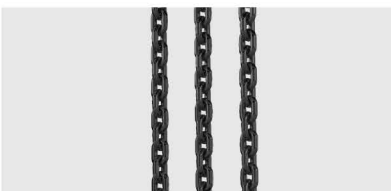

### Load chain :

The load chain is produced through an integrated manufacturing system under strict quality control. The superstrong and wear-resistant load chain is made from special alloy steel achieve a high level of work safety.



### Bottom hook :

The bottom hook is designed to be comfortable to hold and hang the load. The hook is forged and has excellent strength. It can be rotated 360 degrees. The specially designed safety catch ensures a safety operation.



### Housing :

The body is made by high-strength alloy die-casting integrated molding to resist corrosion. The motor shell is made by plastic to reduce the weight and make heat dissipation better. Good sealing housing protects the hoist from dust and water - IP55.



### Pendant control :

The pendant's control system uses low voltage and comes with an emergency stop to be safe for users. The weight is concentrated on wire rope which greatly improves cable life. Good sealing of pendant control protects dust and water - IP65.

## Electric Chain Hoist - Model BMS-M

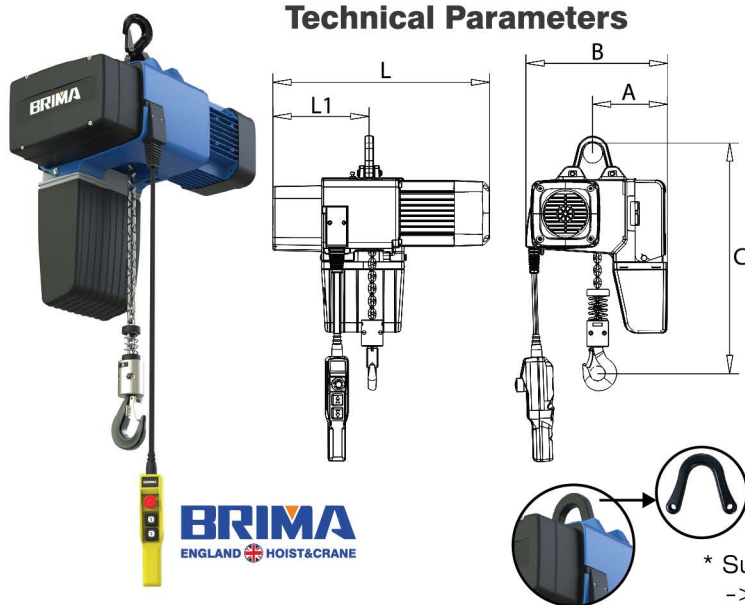

### Main Characteristics

- Motor insulation : Class F
- Duty factor : 60%ED (40/20)
- Duty classification : FEM 2M / ISO M5
- Brake type : DC electromagnetic brake
- Overload protection : Slipping clutch
- Limit switch : Up and Down directions
- Electrical protection : Phase protection
- Motor protection : Temp. switch (2 ton or more)
- Lubrication : Liquid grease / Oil bath
- Hoist protection grade : IP55
- Pendant control : 2 points with emergency
- Control voltage : 24VAC
- Power voltage : 3P 380VAC 50Hz (Standard)  
3P 220VAC 50Hz (Option)  
1P 220VAC 50Hz (Option)

\* Suspension type of top hook is available as an optional.  
-> Recommended using with KH rail (or KBK rail)

Model	Rated Load (kg)	Lifting Speed (m/min)	Lifting Motor Output (kW)	Load Chain		Dimension (mm)					Net Weight (Lift 3 m) (kg)
				Dia. (mm)	No. of falls	L	L1	A	B	C	
BMS0.125-01M	125	2-Speed : 8 / 2	0.4 / 0.1	5.0	1	455	209	160	288	408	24
BMS0.25-01M	250	2-Speed : 8 / 2	0.4 / 0.1	5.0	1	455	209	160	288	408	24
		2-Speed : 12 / 3	0.8 / 0.2	5.0	1	490	218	170	320	420	31
		2-Speed : 16 / 4	1.8 / 0.45	7.1	1	564	254	182	343	516	56
BMS0.5-02M	500	2-Speed : 4 / 1	0.4 / 0.1	5.0	2	455	209	160	288	491	35
BMS0.5-01M	500	2-Speed : 8 / 2	0.8 / 0.2	5.0	1	490	218	170	320	420	31
		2-Speed : 12 / 3	1.8 / 0.45	7.1	1	564	254	182	343	516	56
		2-Speed : 16 / 4	2.3 / 0.6	7.1	1	641	254	182	343	516	68
		1-Speed : 8 (INV.)	0.8	5.0	1	490	218	170	320	420	31
BMS01-02M	1,000	2-Speed : 4 / 1	0.8 / 0.2	5.0	2	490	218	170	320	503	35
BMS01-01M	1,000	2-Speed : 8 / 2	1.8 / 0.45	7.1	1	564	254	182	343	516	56
		2-Speed : 12 / 3	2.3 / 0.6	7.1	1	641	254	182	343	516	68
		1-Speed : 8 (INV.)	1.8	7.1	1	564	254	182	343	516	56
BMS02-02M	2,000	2-Speed : 4 / 1	1.8 / 0.45	7.1	2	564	289	182	343	615	65
BMS02-01M	2,000	2-Speed : 8 / 2	3.6 / 0.9	10.0	1	741	361	268	503	609	126
		1-Speed : 8 (INV.)	3.6	10.0	1	741	361	268	503	609	126
BMS03-02M	3,000	2-Speed : 4 / 1	3.6 / 0.9	10.0	2	741	361	268	503	731	140
BMS03-01M	3,000	2-Speed : 6.4 / 1.6	4.0 / 1.0	11.2	1	741	361	268	503	667	144
BMS05-02M	5,000	2-Speed : 4 / 1	4.0 / 1.0	11.2	2	741	361	268	503	755	150
BMS08-03M	8,000	2-Speed : 2.7 / 0.9	4.0 / 1.0	11.2	3	Request for dimension					

\* Height of lift can be changed upon the usage.

\* For other lifting speed, Please contact our sale department.

# Electric Chain Hoist BMS Series

## Electric Chain Hoist with Electric Trolley - Model BMS-MET



### Technical Parameters

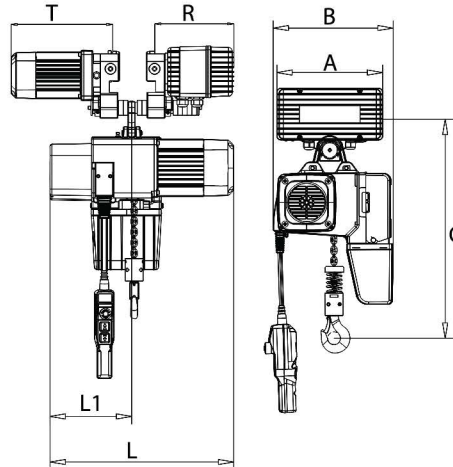

### Main Characteristics

- Motor insulation : Class F
- Duty factor : 60%ED (40/20)
- Duty classification : FEM 2M / ISO M5
- Brake type : DC electromagnetic brake
- Overload protection : Slipping clutch
- Limit switch : Up and Down directions
- Electretrical protection : Phase protection
- Motor protection : Temp. switch (2 ton or more)
- Lubrication : Liquid grease / Oil bath
- Hoist protection grade : IP55
- Pendant control : 4 points with emergency
- Control voltage : 24VAC
- Power voltage : 3P 380VAC 50Hz (Standard)  
3P 220VAC 50Hz (Option)  
1P 220VAC 50Hz (Option)
- Traversing beam width :
  - 75 - 175 mm for 500 kg or less.
  - 75 - 200 mm for 1 ton or more.
- Traversing speed :
  - 1-speed : 18 or 12 m/min. (Standard)
  - 2-speed : 20 / 5 m/min. (Inverter)

Model	Rated Load (kg)	Lifting Speed (m/min)	Lifting Motor Output (kW)	Load Chain		Traversing Motor Output (kW)	Dimension (mm)						Net Weight (Lift 3 m) (kg)	
				Dia. (mm)	No. of falls		L	L1	T	R	A	B		C
BMS0.125-01MET	125	2-Speed : 8 / 2	0.4 / 0.1	5.0	1	0.4	455	209	271	211	282	288	478	41
BMS0.25-01MET	250	2-Speed : 8 / 2	0.4 / 0.1	5.0	1		455	209	271	211	282	288	478	41
		2-Speed : 12 / 3	0.8 / 0.2	5.0	1		490	218	271	211	282	320	490	48
BMS0.5-02MET	500	2-Speed : 16 / 4	1.8 / 0.45	7.1	1		564	254	282	206	293	343	579	84
		2-Speed : 4 / 1	0.4 / 0.1	5.0	2		455	209	271	211	282	288	478	52
BMS0.5-01MET	500	2-Speed : 8 / 2	0.8 / 0.2	5.0	1		490	218	271	211	282	320	490	48
		2-Speed : 12 / 3	1.8 / 0.45	7.1	1		564	254	282	206	293	343	579	84
		2-Speed : 16 / 4	2.3 / 0.6	7.1	1		641	254	282	206	293	343	579	96
		1-Speed : 8 (INV.)	0.8	5.0	1		490	218	271	211	282	320	490	48
BMS01-02MET	1,000	2-Speed : 4 / 1	0.8 / 0.2	5.0	2		490	218	282	206	282	320	573	63
BMS01-01MET	1,000	2-Speed : 8 / 2	1.8 / 0.45	7.1	1		564	254	282	206	293	343	579	84
		2-Speed : 12 / 3	2.3 / 0.6	7.1	1		564	254	282	206	293	343	579	96
		1-Speed : 8 (INV.)	1.8	7.1	1		564	254	282	206	293	343	579	84
BMS02-02MET	2,000	2-Speed : 4 / 1	1.8 / 0.45	7.1	2		564	289	282	206	330	343	685	100
BMS02-01MET	2,000	2-Speed : 8 / 2	3.6 / 0.9	10.0	1		741	361	284	207	330	503	668	161
		1-Speed : 8 (INV.)	3.6	10.0	1		741	361	284	207	330	503	668	161
BMS03-02MET	3,000	2-Speed : 4 / 1	3.6 / 0.9	10.0	2	741	361	350	239	340	503	793	172	
BMS03-01MET	3,000	2-Speed : 6.4 / 1.6	4.0 / 1.0	11.2	1	741	361	350	239	340	503	720	176	
BMS05-02MET	5,000	2-Speed : 4 / 1	4.0 / 1.0	11.2	2	741	361	356	222	400	503	812	205	
BMS08-03MET	8,000	2-Speed : 2.7 / 0.9	4.0 / 1.0	11.2	3	Request for dimension								

\* Height of lift can be changed upon the usage.  
\* For other lifting speed, Please contact our sale department.

## Low-headroom Type Electric Chain Hoist with Electric Trolley Model BMS-ML



### Technical Parameters

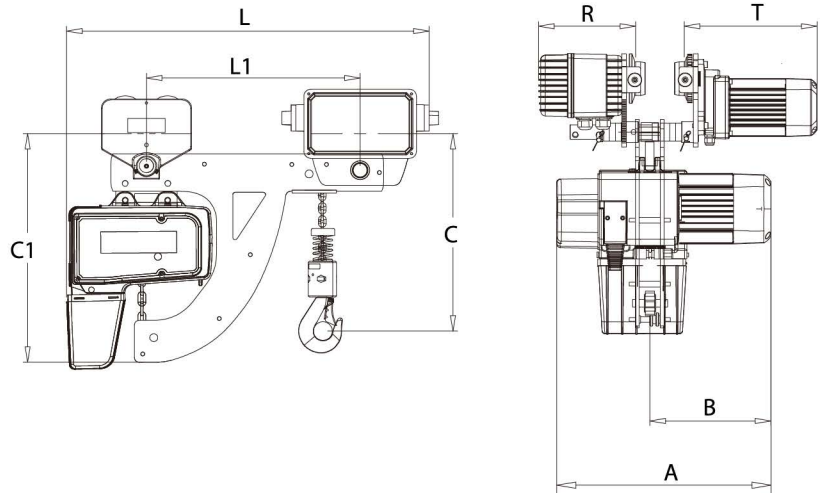

### Main characteristics

- Motor insulation : Class F
- Duty : 60%ED (40/20), FEM 2M / ISO M5
- Brake type : DC electromagnetic brake
- Overload protection : Slipping clutch
- Limit switch : Up and Down directions
- Lubrication : Liquid grease / Oil bath
- Hoist protection grade : IP55
- Pendant control : 4 points with emergency
- Control voltage : 24VAC
- Power voltage : 3P 380VAC 50Hz
- Traversing beam width :
  - 250 kg - 5.0 Ton : 100 - 180 mm
  - 8.0 Ton : 150 - 180 mm
- Traversing speed :
  - 1-speed : 18 or 12 m/min. (Standard)
  - 2-speed : 20 / 5 m/min. (Inverter)

Model	Rated Load (kg)	Lifting Speed (m/min)	Lifting Motor Output (kW)	Load Chain		Traversing Motor Output (kW)	Dimension (mm)							
				Dia. (mm)	No. of falls		L	L1	T	R	A	B	C	C1
BMS0.25-01ML	250	2-Speed : 8 / 2	0.8 / 0.2	5.0	1	0.4	770	453	271	211	490	257	330	490
BMS0.5-01ML	500	2-Speed : 8 / 2	0.8 / 0.2	5.0	1		770	453	271	211	490	257	330	490
BMS01-02ML	1,000	2-Speed : 4 / 1	0.8 / 0.2	5.0	2		770	453	282	206	490	257	410	490
BMS01-01ML	1,000	2-Speed : 8 / 2	1.8 / 0.45	7.1	1		863	548	282	206	630	292	375	630
BMS02-02ML	2,000	2-Speed : 4 / 1	1.8 / 0.45	7.1	2	0.55	891	548	284	207	630	292	485	630
BMS02-01ML	2,000	2-Speed : 8 / 2	3.6 / 0.9	10.0	1		1123	680	284	207	720	380	391	720
BMS2.5-01ML	2,500	2-Speed : 8 / 2	4.0 / 1.0	11.2	1	0.75	1185	745	350	239	720	380	429	720
BMS03-02ML	3,000	2-Speed : 4 / 1	3.6 / 0.9	10.0	2		1185	745	350	239	720	380	508	720
BMS05-02ML	5,000	2-Speed : 4 / 1	4.0 / 1.0	11.2	2	1.1	1245	775	356	222	720	380	543	720
BMS08-03ML	8,000	2-Speed : 4 / 1	2.7 / 0.9	11.2	3		1444	966	356	222	741	381	653	735

\* Height of lift can be changed upon the usage.

# Electric Chain Hoist BMS Series

## Electric Chain Hoist with Electric Trolley Model BMS-MET (10 ton or more)

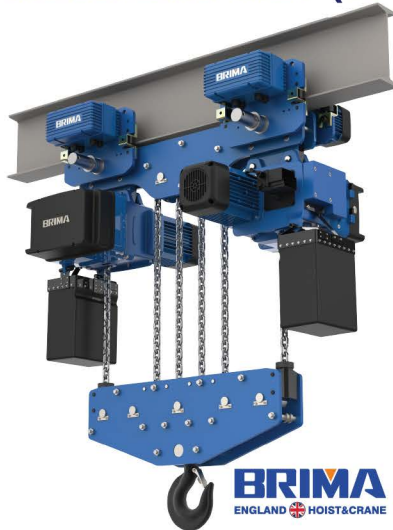

### Technical Parameters

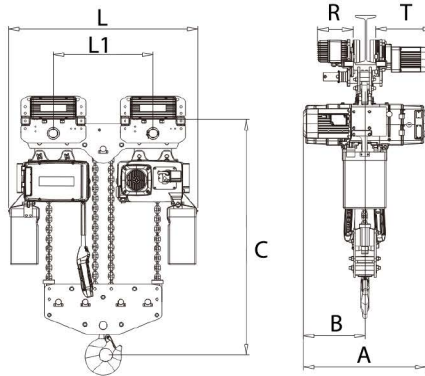

### Main Characteristics

- Motor insulation : Class F
- Duty factor : 60%ED (40/20)
- Duty classification : FEM 2M / ISO M5
- Brake type : DC electromagnetic brake
- Overload protection : Slipping clutch
- Limit switch : Up and Down directions
- Electretical protection : Phase protection
- Motor protection : Temp. switch
- Lubrication : Liquid grease / Oil bath
- Hoist protection grade : IP55
- Pendant control : 4 points with emergency
- Control voltage : 24VAC
- Power voltage : 3P 380VAC 50Hz
- Traversing beam width : 150 - 200 mm
- Traversing speed :
  - 1-speed : 18 or 12 m/min. (Standard)
  - 2-speed : 20 / 5 m/min. (Inverter)

Model	Rated Load (kg)	Lifting Speed (m/min)	Lifting Motor Output (kW)	Load Chain		Traversing Motor Output (kW)	Dimension (mm)						
				Dia. (mm)	No. of falls		L	L1	T	R	A	B	C
BMS10-04MET	10,000	2-Speed : 4 / 1	2 x 4.0 / 1.0	11.2	4	2 x 1.1	1185	632	356	222	757	378	962
BMS16-06MET	16,000	2-Speed : 2.7 / 0.9	2 x 4.0 / 1.0	11.2	6	2 x 1.1	1421	868	361	225	757	378	1024
BMS20-08MET	20,000	2-Speed : 2 / 0.5	2 x 4.0 / 1.0	11.2	8	2 x 1.1	Request for dimension						

\* Height of lift can be changed upon the usage.

## Low-headroom Type Electric Chain Hoist with Electric Trolley Model BMS-ML (10 ton or more)



### Technical Parameters

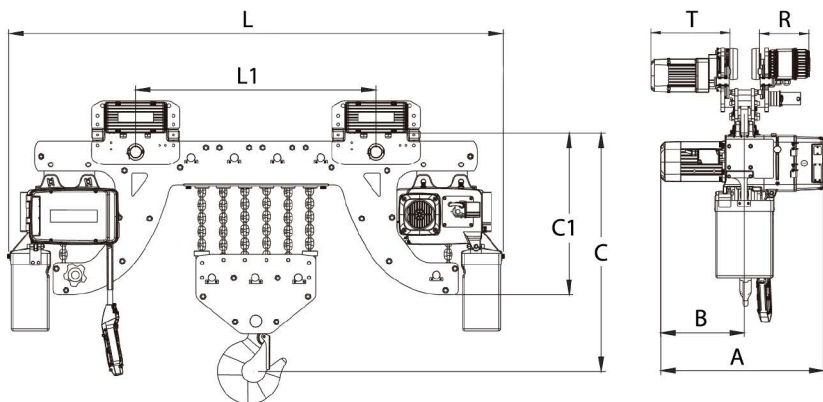

Model	Rated Load (kg)	Lifting Speed (m/min)	Lifting Motor Output (kW)	Load Chain		Traversing Motor Output (kW)	Dimension (mm)							
				Dia. (mm)	No. of falls		L	L1	T	R	A	B	C	C1
BMS10-04ML	10,000	2-Speed : 4 / 1	2 x 4.0 / 1.0	11.2	4	2 x 1.1	2049	895	356	222	741	381	670	735
BMS16-06ML	16,000	2-Speed : 2.7 / 0.9	2 x 4.0 / 1.0	11.2	6	2 x 1.1	2245	1090	356	225	741	381	805	735
BMS20-08ML	20,000	2-Speed : 2 / 0.5	2 x 4.0 / 1.0	11.2	8	2 x 1.1	2450	1290	361	226	741	381	836	757

\* Height of lift can be changed upon the usage.

## Electric Chain Hoist with Manual Trolley - Model BMS-MMT



### Technical Parameters

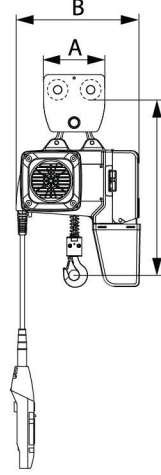
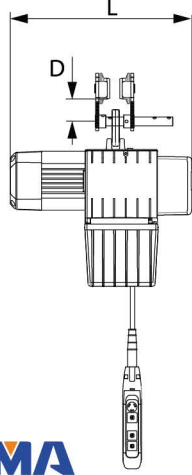

### Main Characteristics

- Motor insulation : Class F
- Duty factor : 60%ED (40/20)
- Duty classification : FEM 2M / ISO M5
- Brake type : DC electromagnetic brake
- Overload protection : Slipping clutch
- Limit switch : Up and Down directions
- Electrical protection : Phase protection
- Motor protection : Temp. switch (2 ton or more)
- Lubrication : Liquid grease / Oil bath
- Hoist protection grade : IP55
- Pendant control : 2 points with emergency
- Control voltage : 24VAC
- Power voltage : 3P 380VAC 50Hz (Standard)  
3P 220VAC 50Hz (Option)  
1P 220VAC 50Hz (Option)
- Traversing beam width :
  - 75 - 175 mm for 500 kg or less.
  - 75 - 200 mm for 1 ton or more.

Model	Rated Load (kg)	Lifting Speed (m/min)	Lifting Motor Output (kW)	Load Chain		Dimension (mm)					Net Weight (Lift 3 m) (kg)
				Dia. (mm)	No. of falls	L	A	B	C	D	
BMS0.125-01MMT	125	2-Speed : 8 / 2	0.4 / 0.1	5.0	1	455	192	288	478	70	31
BMS0.25-01MMT	250	2-Speed : 8 / 2	0.4 / 0.1	5.0	1	455	192	288	478	70	31
		2-Speed : 12 / 3	0.8 / 0.2	5.0	1	490	192	320	490	70	38
		2-Speed : 16 / 4	1.8 / 0.45	7.1	1	564	293	343	579	78	71
BMS0.5-02MMT	500	2-Speed : 4 / 1	0.4 / 0.1	5.0	2	455	192	288	561	70	42
BMS0.5-01MMT	500	2-Speed : 8 / 2	0.8 / 0.2	5.0	1	490	192	320	490	70	38
		2-Speed : 12 / 3	1.8 / 0.45	7.1	1	564	293	343	579	78	71
		2-Speed : 16 / 4	2.3 / 0.6	7.1	1	641	293	343	579	78	83
		1-Speed : 8 (INV.)	0.8	5.0	1	490	192	320	490	70	38
BMS01-02MMT	1,000	2-Speed : 4 / 1	0.8 / 0.2	5.0	2	490	192	320	573	70	50
BMS01-01MMT	1,000	2-Speed : 8 / 2	1.8 / 0.45	7.1	1	564	293	343	579	78	71
		2-Speed : 12 / 3	2.3 / 0.6	7.1	1	564	293	343	579	78	83
		1-Speed : 8 (INV.)	1.8	7.1	1	564	293	343	579	78	71
BMS02-02MMT	2,000	2-Speed : 4 / 1	1.8 / 0.45	7.1	2	564	330	343	685	74	88
BMS02-01MMT	2,000	2-Speed : 8 / 2	3.6 / 0.9	10.0	1	741	330	503	668	74	149
		1-Speed : 8 (INV.)	3.6	10.0	1	741	330	503	668	74	149
BMS03-02MMT	3,000	2-Speed : 4 / 1	3.6 / 0.9	10.0	2	741	340	503	793	71	172
BMS03-02MMT	3,000	2-Speed : 6.4 / 1.6	4.0 / 1.0	11.2	1	741	340	503	720	71	176
BMS05-02MMT	5,000	2-Speed : 4 / 1	4.0 / 1.0	11.2	2	741	400	503	812	86	205
BMS08-03MMT	8,000	2-Speed : 2.7 / 0.9	4.0 / 1.0	11.2	3	Request for dimension					

\* Height of lift can be changed upon the usage.

\* For other lifting speed, Please contact our sale department.

# Electric & Manual Trolley BMS Series



## Electric Chain Hoist with Motorized Trolley - Model ET

### Technical Parameters

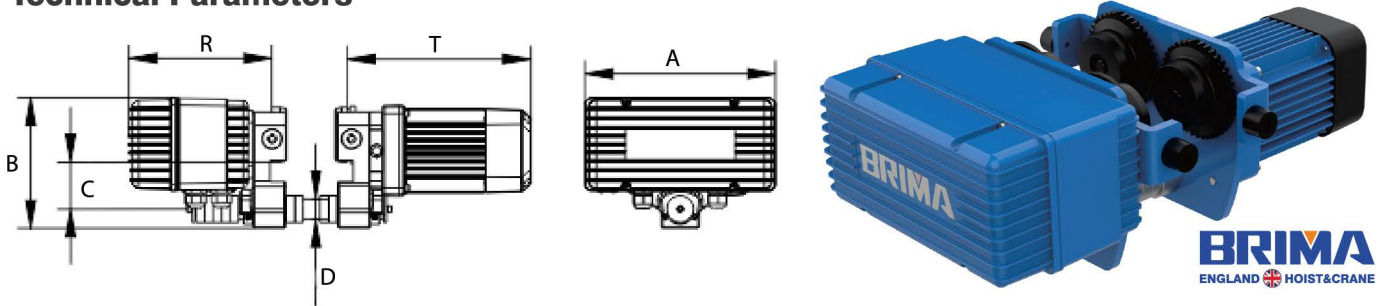

Model	Rated Load (kg)	Traversing Speed (m/min)		Motor Output (kW)	Dimension (mm)						Beam Width (mm)	Net Weight (kg)
		Single	Dual (Inverter)		A	B	C	D	T	R		
ET-0.5	500	Fast : 18 Slow : 12	20 / 5	0.4	282	193	70	30	271	211	75 - 175	17
ET-01	1,000	Fast : 18 Slow : 12	20 / 5	0.4	293	201	78	31	282	206	75 - 200	28
ET-02	2,000	Fast : 18 Slow : 12	20 / 5	0.55	330	217	74	36	284	207	75 - 200	35
ET-03	3,000	Fast : 18 Slow : 12	20 / 5	0.75	340	250	71	43	350	239	75 - 200	55
ET-05	5,000	Fast : 18 Slow : 12	20 / 5	1.1	400	291	86	54	356	222	75 - 200	76

## Manual Trolley - Model MT

### Technical Parameters

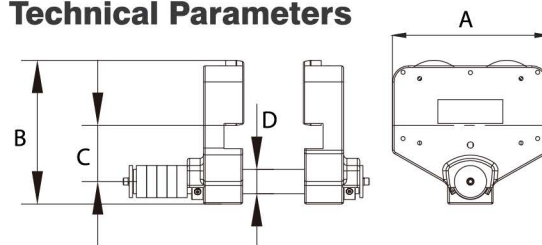
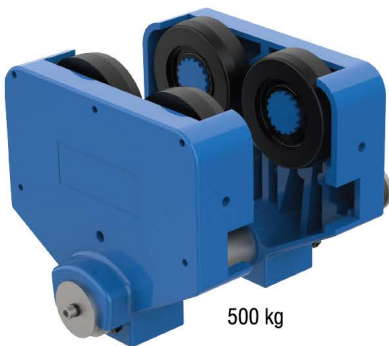

Model	Rated Load (kg)	Dimension (mm)				Beam Width (mm)	Net Weight (kg)
		A	B	C	D		
MT-0.5	500	192	193	70	30	75 - 175	7
MT-01	1,000	293	201	78	31	75 - 200	15
MT-02	2,000	330	217	74	36	75 - 200	23
MT-03	3,000	340	250	71	43	75 - 200	32
MT-05	5,000	400	291	86	54	75 - 200	55

## Double Hook Type Electric Chain Hoist with Electric Trolley Model BMS-MD



### Technical Parameters

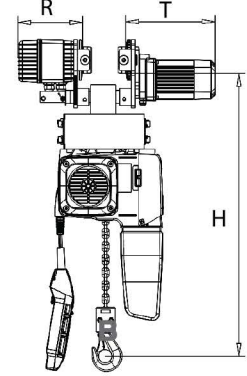
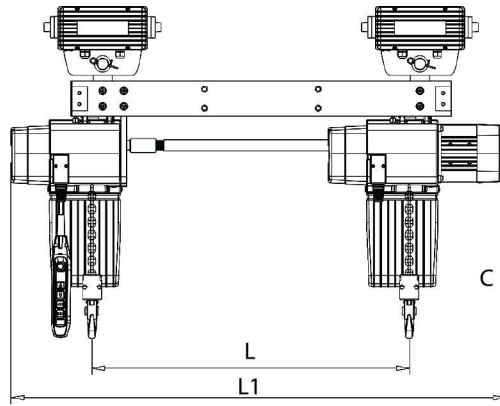

Model	Rated Load (kg)	Lifting Speed (m/min)	Lifting Motor Output (kW)	Load Chain		Traversing Motor Output (kW)	Dimension (mm)				
				Dia. (mm)	No. of falls		L	L1	T	R	H
BMS0.125-01MD	125+125	2-Speed : 8 / 2	0.8 / 0.2	5.0	1	0.4	Upon Request	L+490	271	211	570
BMS0.25-01MD	250+250	2-Speed : 8 / 2	0.8 / 0.2	5.0	1			L+490	271	211	570
BMS0.5-02MD	500+500	2-Speed : 4 / 1	0.8 / 0.2	5.0	2			L+490	271	211	653
BMS0.5-01MD	500+500	2-Speed : 8 / 2	1.8 / 0.45	7.1	1			L+565	282	206	671
BMS01-02MD	1,000+1,000	2-Speed : 4 / 1	1.8 / 0.45	7.1	2	0.55		L+565	284	207	770

\* Height of lift can be changed upon the usage

## Hand Control Type Electric Chain Hoist with Electric Trolley Model BMS-MH



### Technical Parameters

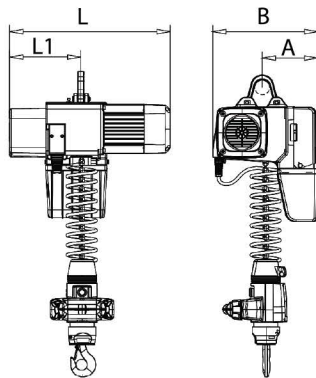

### Main Characteristics

- Motor insulation : Class F
- Duty factor : 60%ED (40/20)
- Duty classification : FEM 2M / ISO M5
- Brake type : DC electromagnetic brake
- Overload protection : Slipping clutch
- Limit switch : Up and Down directions
- Lubrication : Oil bath
- Hoist protection grade : IP55
- Pendant control : 2 points with emergency
- Control voltage : 24VAC
- Power voltage : 3P 380VAC 50Hz (Standard)  
3P 220VAC 50Hz (Option)  
1P 220VAC 50Hz (Option)

Model	Rated Load (kg)	Lifting Speed (m/min)	Lifting Motor Output (kW)	Load Chain		Dimension (mm)			
				Dia. (mm)	No. of falls	L	L1	A	B
BMS0.125-01MH	125	2-Speed : 8 / 2	0.4 / 0.1	5.0	1	511	265	159	288
		2-Speed : 16 / 4	0.8 / 0.2	5.0	1	541	271	170	320
BMS0.25-01MH	250	2-Speed : 8 / 2	0.4 / 0.1	5.0	1	511	265	159	288
		2-Speed : 12 / 3	0.8 / 0.2	5.0	1	541	271	170	320
BMS0.5-01MH	500	2-Speed : 8 / 2	0.8 / 0.2	5.0	1	541	271	170	320

# Electric Chain Hoist BMS & BMA Series

## Electric Chain Hoist with Balance Function - Model BMS-ZNL

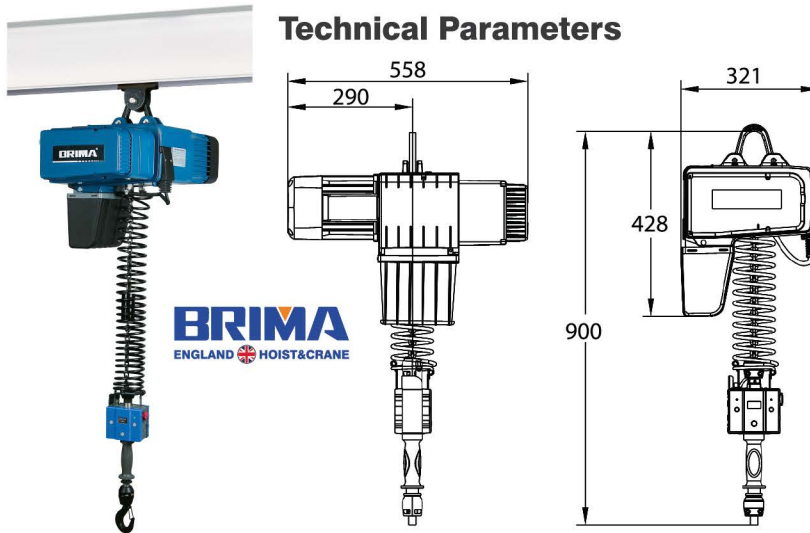

### Main Characteristics

- Motor insulation : Class F
- Duty classification :
  - 80 kg - 250 kg : FEM 4M / ISO M7
  - 500 kg : FEM 2M / ISO M5
- Brake type : DC electromagnetic brake
- Overload protection : Load cell Type
- Limit switch : Software and Hardware
- Lubrication : Oil bath
- Hoist protection grade : IP55
- Pendant control : Hand grip with emergency
- Power voltage : 1P 220VAC 50Hz

### Main Features

- > Handle control mode
  - controlled by sliding hand grip (Up/Down)
- > Load positioning control mode
  - controlled by holding the load by hand and applying light force to hoisting or lowering inhibit load swing and uncontrolled movement, so the operation has a high safety and precision.

Model	Rated Load (kg)	Maximum Lifting Speed (m/min)	Lifting Motor Output (kW)	Load Chain	
				Dia. (mm)	No. of falls
BMS-ZNL80	80	20	1.1	5.0	1
BMS-ZNL125	125	20			
BMS-ZNL250	250	16			
BMS-ZNL500	500	8			

## Electric Wire Rope Hoist with Balance Function - Model BMA

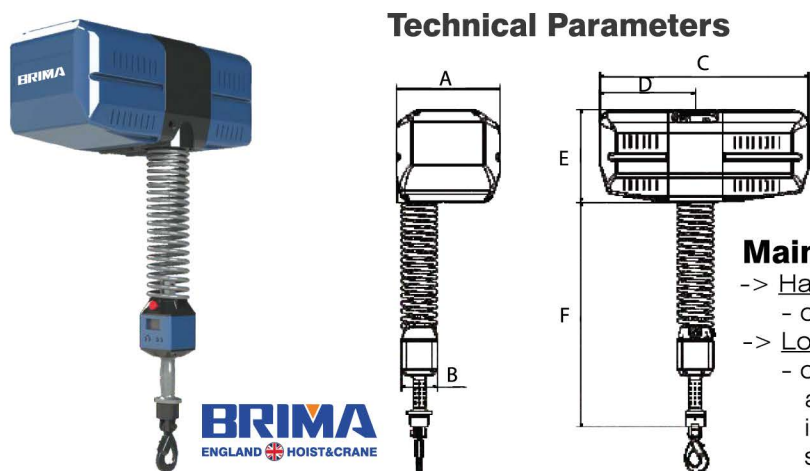

### Main Characteristics

- Pendant control : 2 points with emergency
- Overload protection : Load cell Type
- Limit switch : Software and Hardware
- Pendant control : Hand grip with emergency
- Power voltage : 1P 220VAC 50Hz

### Main Features

- > Handle control mode
  - controlled by sliding hand grip (Up/Down)
- > Load positioning control mode
  - controlled by holding the load by hand and applying light force to hoisting or lowering inhibit load swing and uncontrolled movement, so the operation has a high safety and precision.

Model	Rated Load (kg)	Max. Lifting Speed (m/min)		Max. Lifting Stroke (m)	Lifting Motor Output (kW)	Wire Rope Dia. (mm)	Dimension (mm)					
		Handle	Load positioning				A	B	C	D	E	F
BMA100	100	40	36	3.5	0.75	5.0	323	112	649	297	291	610
BMA200	200	30	27	3.5	1.5							
BMA300	300	15	13.5	3.5	2.0							
BMA600	600	7.5	6.75	1.7	2.0							6.5

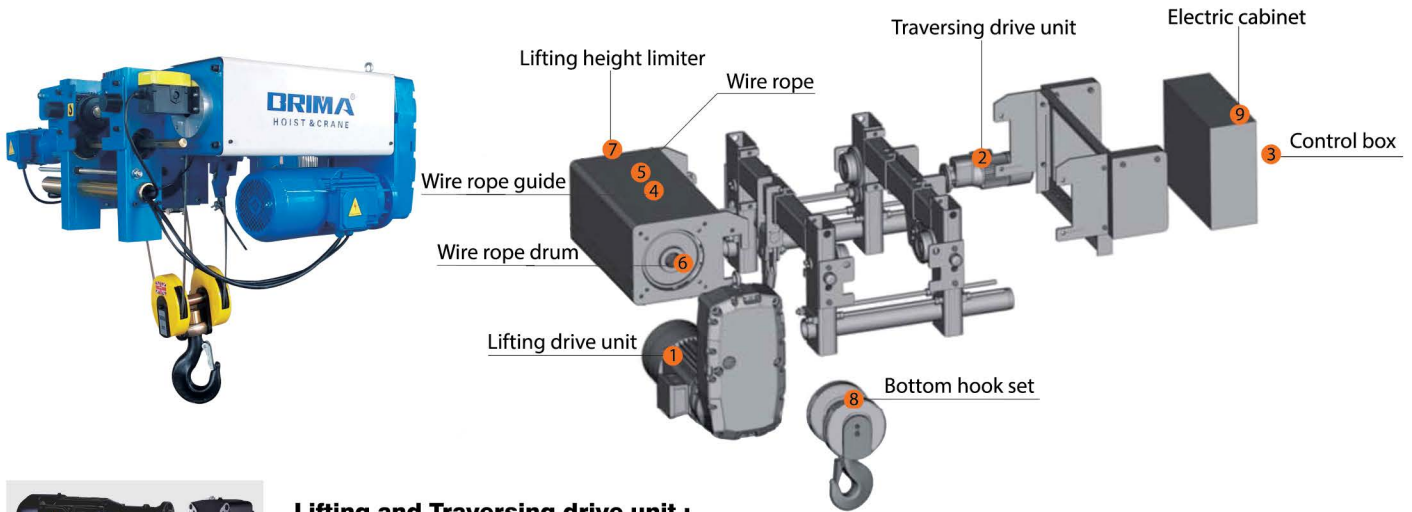

**Lifting and Traversing drive unit :**

The BMG's motor with reduction gear box has high-performance and compact structure. But it consumes low energy, and has low noise. The duty factor is up to 60% (40/20). Due to asbestos-free brake, service life can be up to 1 million times. High protection grade of brake can meet the requirements of severe environment.



**Wire rope guide :**

The guide is light weight and wear resistance designed, to reduce the wear of wire rope. The guide prevents wire rope from skipping and losing to off-groove.



**Wire rope :**

The BMG hoist use high performance wire rope, tensile strength up to 2,160 MPa. The surface is galvanized for corrosion prevention effectively. Also, the high flexibility structure of wire rope ensures wear resistance and prolongs its service life.



**Wire rope drum :**

The drum is produced with Q345 seamless steel tube and a number of working procedure to ensure concentricity of drum. The depth of groove is in compliance with FEM standard. High-strength pressing plates and bolts are fastened on the end of wire rope for safety.



**Lifting height limiter :**

The limiter can be wide range adjusted with high precision. Multiple-contact configurations can effectively achieve the function of transition (lifting and lowering with 2-speed).



**Bottom hook set :**

The bottom hook is forged by the high-strength material of T grade. The hook with safety latch and wire rope sheath ergonomic design is in compliance with DIN standard.



**Electric control box :**

All of the electrical components is high quality and reliable. Multiple safety protection devices are added to ensure more safety. The design with clear identification makes it easy to troubleshoot. Good sealing housing protects the control circuit from dust and water - IP55.

# Electric Wire Rope Hoist BMG Series



## Single Girder Type Electric Wire Rope Hoist with Electric Trolley Model BMG-S



### Technical Parameters

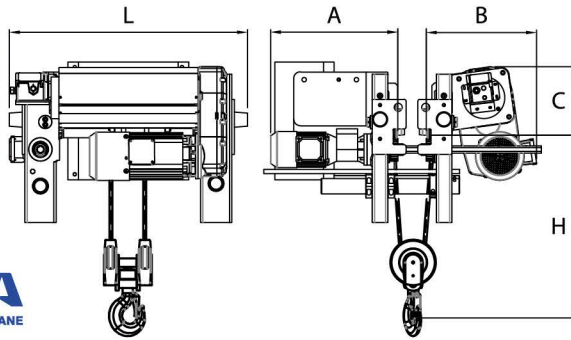

### Main Characteristics

- Motor insulation : Class F
- Duty factor : 60%ED (40/20)
- Brake type : DC brake
- Overload protection : Load cell
- Limit switch : Up-Down direction
- Elec. protection : Phase protection
- Motor protection : Temp. switch
- Lubrication : Oil bath
- Pendant control : 6 points+Emer
- Control voltage : 48VAC
- Power voltage : 3P 380VAC 50Hz
- Reeving : 4/1 (Std.), 4/2 (Option)
- Protection Grade : IP 55 / IP 54

Model	Rated Load (ton)	Speed (m/min)	Motor Output (kW)	Duty Class.	Wire Rope	Lifting Height (m)	Dimension (mm)					Beam Width (mm)
							L	H	A	B	C	
BMG-3.2S	3.2	Lifting 2-Speed : 5 / 0.8  Traversing 2-Speed : 20 / 5	Lifting 3.2 / 0.45  Traversing 0.64 (Inverter)	FEM : 2M ISO : M5	Dia. 6.0 mm Reeving 4/1	6.0	913	696	540	450	188	150 - 410
						9.0	1,063					
						12.0	1,263					
						15.0	1,463					
BMG-5.0S	5.0	Lifting 2-Speed : 5 / 0.8  Traversing 2-Speed : 20 / 5	Lifting 6.1 / 1.0  Traversing 0.64 (Inverter)	FEM : 2M ISO : M5	Dia. 8.0 mm Reeving 4/1	6.0	905	696	510	480	180	150 - 400
						9.0	1,055					
						12.0	1,255					
						15.0	1,455					
BMG-8.0S	8.0	Lifting 2-Speed : 5 / 0.8  Traversing 2-Speed : 20 / 5	Lifting 9.5 / 1.5  Traversing 0.96 (Inverter)	FEM : 3M ISO : M6	Dia. 11.0 mm Reeving 4/1	6.0	1,065	750	580	610	325	200 - 450
						9.0	1,215					
						12.0	1,415					
						15.0	1,615					
BMG-10.0S	10.0	Lifting 2-Speed : 5 / 0.8  Traversing 2-Speed : 20 / 5	Lifting 9.5 / 1.5  Traversing 0.96 (Inverter)	FEM : 2M ISO : M5	Dia. 11.0 mm Reeving 4/1	6.0	1,065	750	580	610	325	200 - 450
						9.0	1,215					
						12.0	1,415					
						15.0	1,615					
BMG-12.5S	12.5	Lifting 2-Speed : 5 / 0.8  Traversing 2-Speed : 20 / 5	Lifting 12.5 / 2.0  Traversing 0.96 (Inverter)	FEM : 1M ISO : M4	Dia. 11.0 mm Reeving 4/1	6.0	1,065	750	580	610	325	200 - 450
						9.0	1,215					
						12.0	1,415					
						15.0	1,615					
BMG-15.0S	15.0	Lifting 2-Speed : 4 / 0.6  Traversing 2-Speed : 20 / 5	Lifting 20.0 / 5.0  Traversing 2 x 0.96 (Inverter)	FEM : 2M ISO : M5	Dia. 15.0 mm Reeving 4/1	6.0	913	1,150	610	610	360	200 - 450
						9.0	1,063					
						12.0	1,263					

\* Height of lift can be changed upon the usage.

\* For other lifting speed, Please contact our sale department.

## Double Girder Type Electric Wire Rope Hoist with Electric Trolley Model BMG-D



### Main Characteristics

- Motor insulation : Class F
- Duty factor : 60%ED (40/20)
- Brake type : DC brake
- Overload protection : Load cell
- Limit switch : Up-Down direction
- Elec. protection : Phase protection
- Motor protection : Temp. switch
- Lubrication : Oil bath
- Pendant control : 6 points+Emer
- Control voltage : 48VAC
- Power voltage : 3P 380VAC 50Hz
- Reeving : 4/1 (Std.), 4/2 (Option)
- Protection Grade : IP 55 / IP 54

Model	Rated Load (ton)	Speed (m/min)	Motor Output (kW)	Duty Class.	Wire Rope	Lifting Height (m)	Standard Rail Gauge L (mm)	Dimension (mm)				
								H	A	B	C	W
BMG-3.2D	3.2	Lifting 2-Speed : 5 / 0.8  Traversing 2-Speed : 20 / 5	Lifting 3.2 / 0.45  Traversing 2 x 0.64 (Inverter)	FEM : 2M ISO : M5	Dia. 6.0 mm Reeving 4/1	6.0	1,200	450	600	720	500	60
						9.0	1,200					
						12.0	1,400					
						15.0	1,400					
BMG-5.0D	5.0	Lifting 2-Speed : 5 / 0.8  Traversing 2-Speed : 20 / 5	Lifting 6.1 / 1.0  Traversing 2 x 0.64 (Inverter)	FEM : 2M ISO : M5	Dia. 8.0 mm Reeving 4/1	6.0	1,200	490	600	720	500	60
						9.0	1,200					
						12.0	1,400					
						15.0	1,400					
BMG-8.0D	8.0	Lifting 2-Speed : 5 / 0.8  Traversing 2-Speed : 20 / 5	Lifting 9.5 / 1.5  Traversing 2 x 0.96 (Inverter)	FEM : 3M ISO : M6	Dia. 11.0 mm Reeving 4/1	6.0	1,200	600	600	730	570	60
						9.0	1,400					
						12.0	1,700					
						15.0	1,700					
BMG-10.0D	10.0	Lifting 2-Speed : 5 / 0.8  Traversing 2-Speed : 20 / 5	Lifting 9.5 / 1.5  Traversing 2 x 0.96 (Inverter)	FEM : 2M ISO : M5	Dia. 11.0 mm Reeving 4/1	6.0	1,200	600	600	730	570	60
						9.0	1,400					
						12.0	1,700					
						15.0	1,700					
BMG-12.5D	12.5	Lifting 2-Speed : 5 / 0.8  Traversing 2-Speed : 20 / 5	Lifting 12.5 / 2.0  Traversing 2 x 0.96 (Inverter)	FEM : 1M ISO : M4	Dia. 11.0 mm Reeving 4/1	6.0	1,200	600	600	730	570	60
						9.0	1,400					
						12.0	1,700					
						15.0	1,700					

\* Height of lift can be changed upon the usage.

\* For other lifting speed, Please contact our sale department.

# Electric Wire Rope Hoist BMG Series

## Double Girder Type Electric Wire Rope Hoist with Electric Trolley Model BMG-D

### Technical Parameters

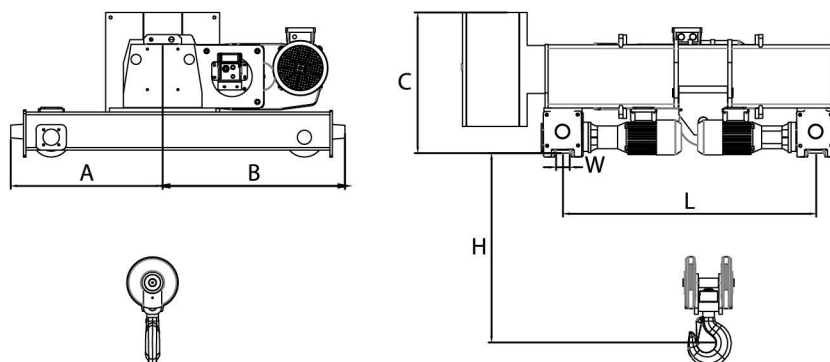

Model	Rated Load (ton)	Speed (m/min)	Motor Output (kW)	Duty Class.	Wire Rope	Lifting Height (m)	Standard Rail Gauge L (mm)	Dimension (mm)				
								H	A	B	C	W
BMG-16.0D	16.0	Lifting 2-Speed : 4 / 0.6 Traversing 2-Speed : 20 / 5	Lifting 20.0 / 4.0 Traversing 2 x 0.96 (Inverter)	FEM : 2M ISO : M5	Dia. 15.0 mm Reeving 4/1	6.0	1,400	890	875	785	770	70
						9.0	1,400					
						12.0	1,700					
						15.0	2,000					
BMG-20.0D	20.0	Lifting 2-Speed : 4 / 0.6 Traversing 2-Speed : 20 / 5	Lifting 20.0 / 4.0 Traversing 2 x 0.96 (Inverter)	FEM : 1M ISO : M4	Dia. 15.0 mm Reeving 4/1	6.0	1,400	890	875	785	770	70
						9.0	1,400					
						12.0	1,700					
						15.0	2,000					
BMG-32.0D	32.0	Lifting 2-Speed : 3.3 / 0.8 Traversing 2-Speed : 20 / 5	Lifting 20.0 / 5.0 Traversing 2 x 1.3 (Inverter)	FEM : 2M ISO : M5	Dia. 11.0 mm Reeving 12/2	6.0	1,700	900	825	1,030	1,000	80
						9.0	2,000					
						12.0	2,400					
						15.0	2,800					
BMG-40.0D	40.0	Lifting 2-Speed : 4.9 / 0.8 Traversing 2-Speed : 20 / 5	Lifting 38.0 (Inverter) Traversing 2 x 1.9 (Inverter)	FEM : 1M ISO : M4	Dia. 15.0 mm Reeving 8/2	6.0	2,000	1,000	1,055	1,055	1,100	90
						9.0	2,200					
						12.0	2,500					
						15.0	2,800					
BMG-50.0D	50.0	Lifting 2-Speed : 3.2 / 0.8 Traversing 2-Speed : 20 / 5	Lifting 38.0 (Inverter) Traversing 2 x 1.9 (Inverter)	FEM : 2M ISO : M5	Dia. 15.0 mm Reeving 12/2	6.0	2,200	1,060	1,085	1,085	1,100	90
						9.0	2,700					
						12.0	3,100					
						15.0	3,600					

\* Height of lift can be changed upon the usage.

\* For other lifting speed, Please contact our sale department.

## Electric Wire Rope Hoist - Model BMG-F

### Technical Parameters

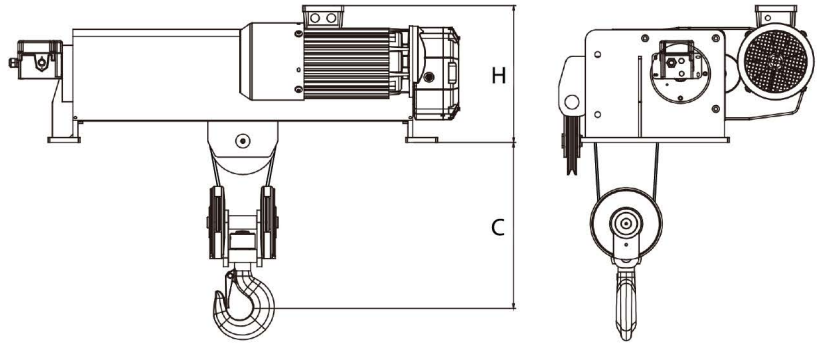

### Main Characteristics

- Motor insulation : Class F
- Duty factor : 60%ED (40/20)
- Brake type : DC electromagnetic brake
- Overload protection : Load cell Type
- Limit switch : Up and Down directions
- Electretrical protection : Phase protection
- Motor protection : Temp. switch
- Lubrication : Oil bath
- Pendant control : 2 points with emergency
- Control voltage : 48VAC
- Power voltage : 3P 380VAC 50Hz
- Reeving : 4/1 (Standard)  
4/2 (Option) - T.V.L. (True Vertical Lift)

Model	Rated Load (ton)	Lifting Height (m)	Speed (m/min)	Motor Output (kW)	Wire Rope	Duty Class.	Dimension (mm)	
							H	C
BMG-3.2F	3.2	6.0 / 9.0 12.0 / 15.0	2-Speed : 5.0 / 0.8	3.2 / 0.45	Dia. 6.0 mm Reeving 4/1	FEM 2M ISO M5	380	620
			1-Speed : 5.0 (Inverter)	3.2 (Inverter)				
			2-Speed : 10.0 / 1.6	6.1 / 1.0	Dia. 8.0 mm Reeving 4/2 (T.V.L.)		400	650
			1-Speed : 10.0 (Inverter)	6.1 (Inverter)				
BMG-5.0F	5.0	6.0 / 9.0 12.0 / 15.0	2-Speed : 5.0 / 0.8	6.1 / 1.0	Dia. 8.0 mm Reeving 4/1	FEM 2M ISO M5	400	650
			1-Speed : 5.0 (Inverter)	6.1 (Inverter)				
			2-Speed : 10.0 / 1.6	9.5 / 1.5	Dia. 11.0 mm Reeving 4/2 (T.V.L.)		510	780
			1-Speed : 10.0 (Inverter)	9.5 (Inverter)				

\* Height of lift can be changed upon the usage.

\* For other lifting speed, Please contact our sale department.

# Electric Hoist BMS & BMG Series

## FEM (9.511) Rating

Load Condition	Average Load ratio	Calculated total operating time (hours)						
		400	800	1,600	3,200	6,300	12,500	25,000
		Average operating time per day (hours)						
		≤0.25	≤0.5	≤1.0	≤2.0	≤4.0	≤8.0	≤16.0
L1 : Light	$K \leq 0.50$	-	1 Dm	1 Cm	1 Bm	1 Am	2 m	3 m
L2 : Medium	$0.50 < K \leq 0.63$	1 Dm	1 Cm	1 Bm	1 Am	2 m	3 m	4 m
L3 : Heavy	$0.63 < K \leq 0.80$	1 Cm	1 Bm	1 Am	2 m	3 m	4 m	5 m
L4 : Severe	$0.80 < K \leq 1.00$	1 Bm	1 Am	2 m	3 m	4 m	5 m	-

## %ED Rating

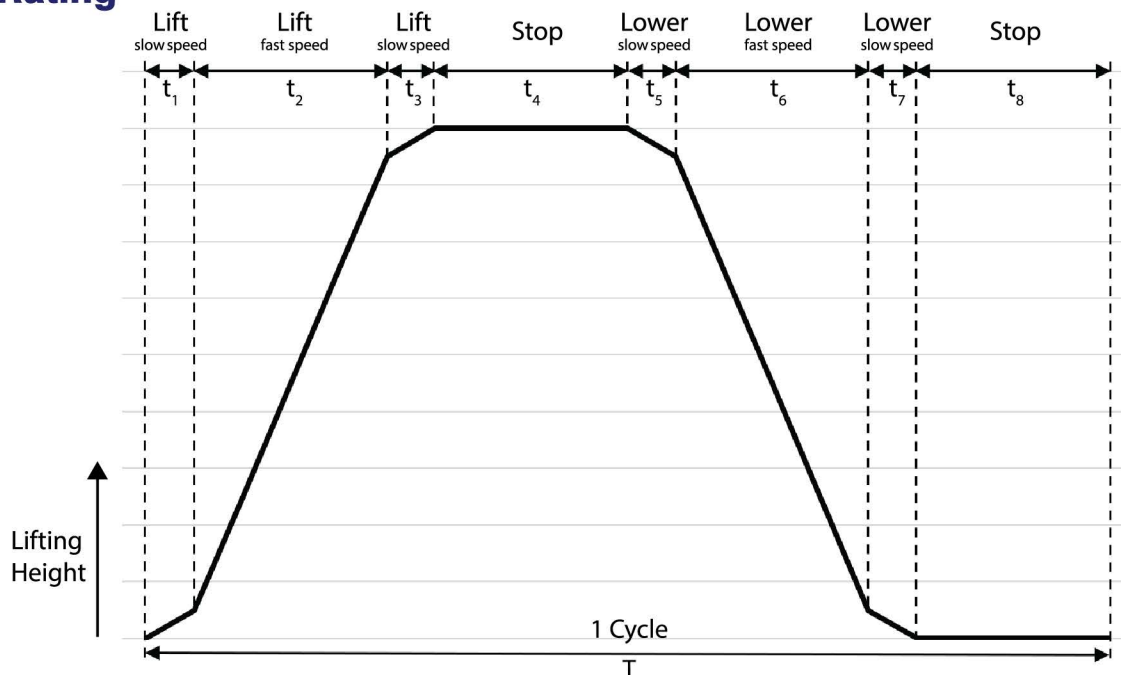

$$\%ED = \frac{(\text{Motor ON time})}{(1 \text{ Cycle})}$$

$$\%ED (1^{\text{st}} \text{ speed}) = (t_1 + t_3 + t_5 + t_7) / T$$

$$\%ED (2^{\text{nd}} \text{ speed}) = (t_2 + t_6) / T$$

$$\%ED = (t_1 + t_2 + t_3 + t_5 + t_6 + t_7) / T$$

$$\text{OFF time / Rest time} = t_4 + t_8$$

Example: 1 Cycle = 1 hour, 60%ED (40/20)

Slow speed ON time = 12 minutes

Fast speed ON time = 24 minutes

Both speed ON time = 36 minutes

OFF time / Rest time = 24 minutes

## Top-running Motorized End Carriages - Model ET

### Technical Parameters

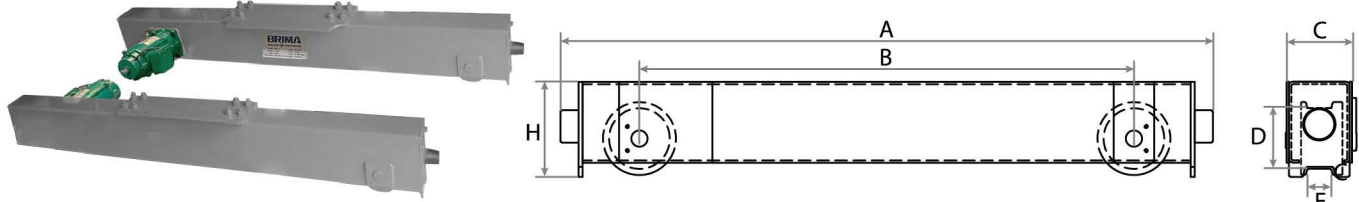

Rated Load (ton)	Max. Span (m)	Model	Speed (m/min)	Motor Output (kW)	Dimension (mm)						Net Weight [per set] (kg)
					A	B	C	D	E	H	
1.0 - 2.0	8.0	ET12-12-2.0	20.0	2 x 0.37	1,566	1,200	150	120	60	165	250
	12.0	ET12-17-2.0			2,066	1,700					286
	16.0	ET12-22-2.0			2,566	2,200					322
	19.0	ET12-27-2.0		3,066	2,700	364					
	23.0	ET15-32-2.0		3,620	3,200	150		70	218	458	
	26.0	ET15-35-2.0		3,920	3,500	268		566			
3.0	8.0	ET12-12-3.0	20.0	2 x 0.37	1,566	1,200	150	120	60	165	250
	12.0	ET12-17-3.0			2,066	1,700					286
	16.0	ET12-22-3.0			2,566	2,200					322
	19.0	ET15-27-3.0		3,120	2,700	218		432			
	23.0	ET15-32-3.0		3,620	3,200	150		70	268	537	
	26.0	ET15-35-3.0		3,920	3,500	318		596			
5.0	8.0	ET15-12-5.0	20.0	2 x 0.4	1,620	1,200	150	150	70	218	306
	12.0	ET15-17-5.0			2,120	1,700					348
	16.0	ET15-22-5.0			2,620	2,200					268
	19.0	ET20-27-5.0		3,180	2,700	578					
	23.0	ET20-32-5.0		3,680	3,200	200		70	320	633	
	26.0	ET20-35-5.0		3,980	3,500	200		826			
7.5	8.0	ET20-12-7.5	20.0	2 x 0.75	1,680	1,200	150	200	70	270	399
	12.0	ET20-17-7.5			2,180	1,700					476
	16.0	ET20-22-7.5			2,680	2,200					320
	19.0	ET25-27-7.5			3,280	2,700	200	250	80	325	786
	23.0	ET25-32-7.5			3,780	3,200					861
	26.0	ET25-35-7.5			4,080	3,500					925
10.0	8.0	ET25-12-10.0	20.0	2 x 0.75	1,780	1,200	200	250	80	325	552
	12.0	ET25-17-10.0			2,280	1,700					628
	16.0	ET25-22-10.0			2,780	2,200					704
	19.0	ET25-27-10.0			3,280	2,700					780
	23.0	ET25-32-10.0			3,780	3,200					980
	26.0	ET25-35-10.0		4,080	3,500	425				1,080	

# End Carriages Top-running Series

## Top-running Motorized End Carriages - Model ET

### Technical Parameters

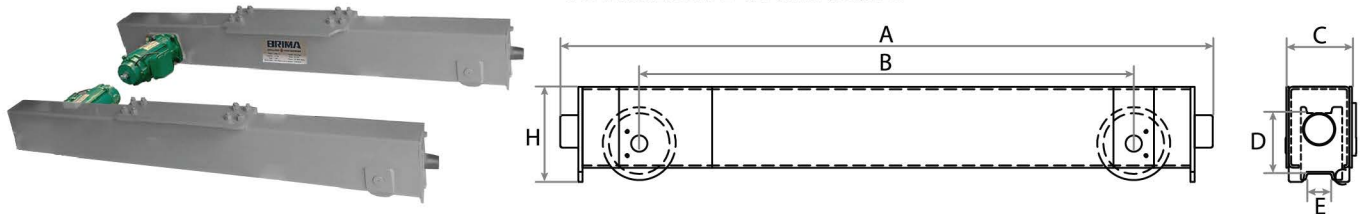

Rated Load (ton)	Max. Span (m)	Model	Speed (m/min)	Motor Output (kW)	Dimension (mm)						Net Weight [per set] (kg)
					A	B	C	D	E	H	
12.5	8.0	ET25-12-12.5	20.0	2 x 0.75	1,780	1,200	200	250	80	325	562
	12.0	ET25-17-12.5			2,280	1,700					638
	16.0	ET315-22-12.5		2 x 1.1	2,880	2,200		315	90	420	982
	23.0	ET315-27-12.5			3,380	2,700					1,090
16.0	8.0	ET315-12-16.0	20.0	2 x 1.1	1,880	1,200	200	315	90	420	795
	12.0	ET315-17-16.0			2,380	1,700					886
	16.0	ET315-22-16.0			2,880	2,200					1,055
	19.0	ET315-27-16.0			3,380	2,700					1,163

\*For other capacity, span and beam width, Please contact our sale department.

## Under-running Motorized End Carriages - Model UT

### Technical Parameters

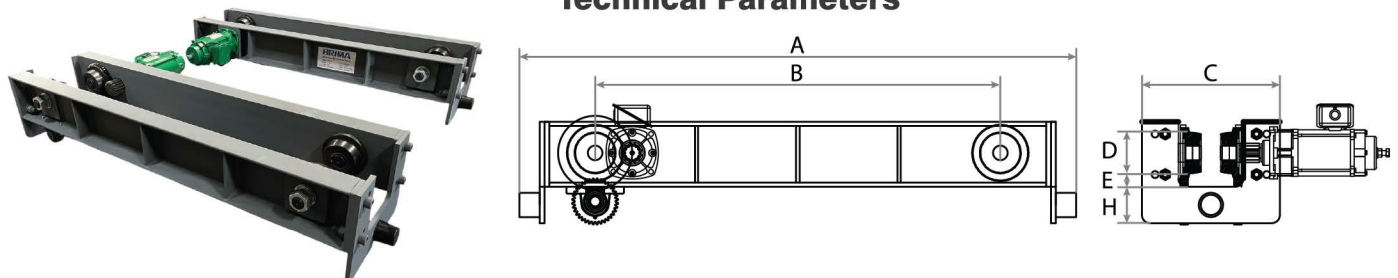

Model	Rated Load (ton)	Max. Span (m)	Speed (m/min)	Motor Output (kW)	Beam Width (mm)	Dimension (mm)						Net Weight [per set] (kg)
						A	B	C	D	E	H	
UT02-10	1.0 - 2.0	8.0	20.0	2 x 0.4	100 / 125 / 150	1,374	1,000	340.6	100	33.5	90.0	200
UT03-12	3.0	10.0	20.0	2 x 0.4	125 / 150 / 175	1,700	1,200	387.1	125	39.8	90.0	320
UT05-15	5.0	12.0	20.0	2 x 1.1	125 / 150 / 175	1,900	1,500	387.1	125	39.8	90.0	320

\*For other capacity, span and beam width, Please contact our sale department.

## Crane Motor with Gear Box - Model BM

BM-030



BM-050



BM-100



### Technical Parameters

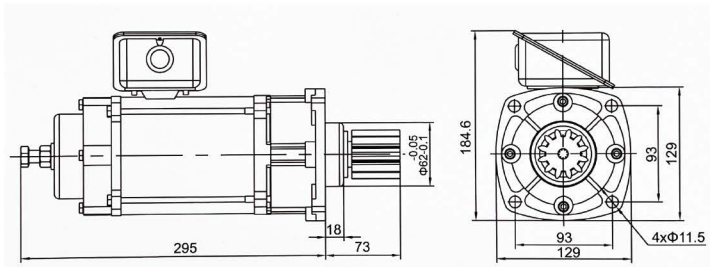

Model	Motor Output (kW x Pole)	Speed (50Hz)	Output Gear (Module x Teeth)
BM-030 (Ratio 10:1) 3P 380V	0.25kW x 4P	150 rpm	M4 x 10T , *
	0.25kW x 6P	90 rpm	*
	0.4kW x 4P	150 rpm	*

\*Can be changed upon request.  
Module: M3, M3.5, M4; Teeth: 10T, 12T, etc.

### Technical Parameters

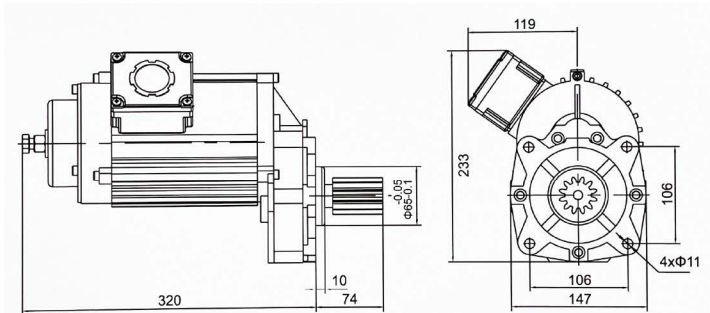

Model	Motor Output (kW x Pole)	Speed (50Hz)	Output Gear (Module x Teeth)
BM-050 (Ratio 8.5:1) 3P 380V	0.4kW x 4P	176 rpm	M4 x 10T , *
	0.37kW x 6P	115 rpm	*
BM-050 QX (Ratio 8.5:1) 3P 380V	0.75kW x 4P	176 rpm	*
	0.6kW x 6P	115 rpm	*

\*Can be changed upon request.  
Module: M3, M3.5, M4; Teeth: 10T, 12T, etc.

### Technical Parameters

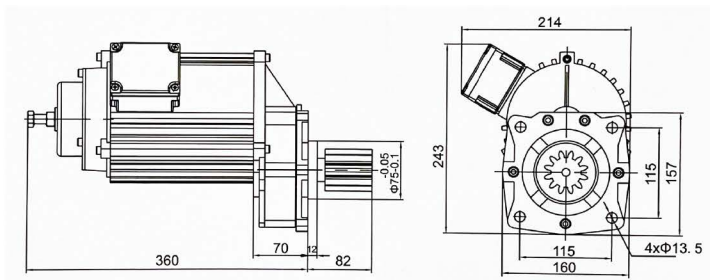

Model	Motor Output (kW x Pole)	Speed (50Hz)	Output Gear (Module x Teeth)
BM-100 (Ratio 7.7:1) 3P 380V	0.75kW x 4P	188 rpm	M4 x 10T , *
	0.6kW x 6P	123 rpm	*
	0.4/0.13kW x 4/12P	188/62 rpm	*
BM-100 QX (Ratio 7.7:1) 3P 380V	1.1kW x 4P	188 rpm	M4 x 13T , *
	0.75kW x 6P	123 rpm	*

\*Can be changed upon request.  
Module: M3, M3.5, M4; Teeth: 10T, 12T, etc.

# Crane Motor BM Series

## Crane Motor with Gear Box - Model BM

BM-150



BM-200

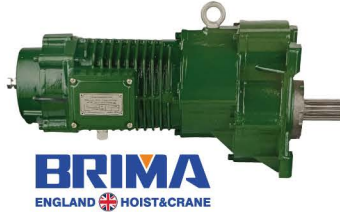

BM-300

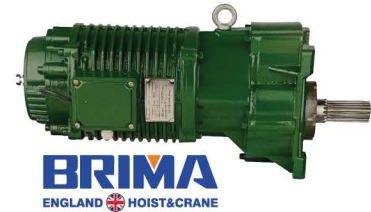

### Technical Parameters

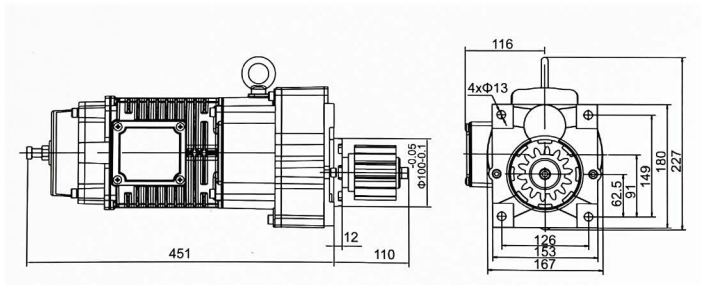

Model	Motor Output (kW x Pole)	Speed (50Hz)	Output Gear (Module x Teeth)
BM-150 (Ratio 13:1) 3P 380V	1.1kW x 4P	114 rpm	*
	0.75kW x 6P	67 rpm	*
	0.6/0.2kW x 4/12P	114/33 rpm	*
BM-150 QX (Ratio 13:1) 3P 380V	1.5kW x 4P	114 rpm	*
	1.1kW x 6P	67 rpm	*

\*Can be changed upon request.  
Module: M3, M3.5, M4; Teeth: 10T, 12T, etc.

### Technical Parameters

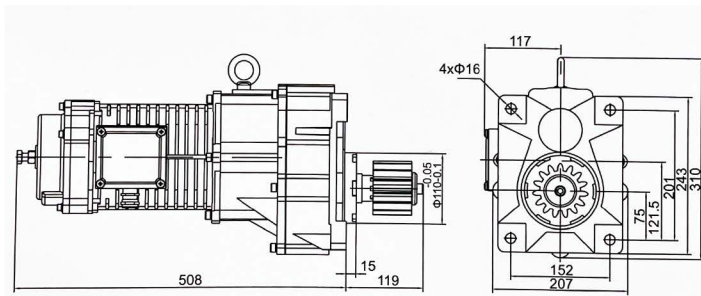

Model	Motor Output (kW x Pole)	Speed (50Hz)	Output Gear (Module x Teeth)
BM-200 (Ratio 16:1) 3P 380V	1.5kW x 4P	92 rpm	M4 x 13T , *
	1.1kW x 4P	92 rpm	*
	1.1kW x 6P	61 rpm	*
	0.75/0.25kW x 4/12P	92/30 rpm	*
BM-200 QX (Ratio 16:1) 3P 380V	2.2kW x 4P	92 rpm	*
	1.5kW x 6P	61 rpm	*

\*Can be changed upon request.  
Module: M3, M3.5, M4; Teeth: 10T, 12T, etc.

### Technical Parameters

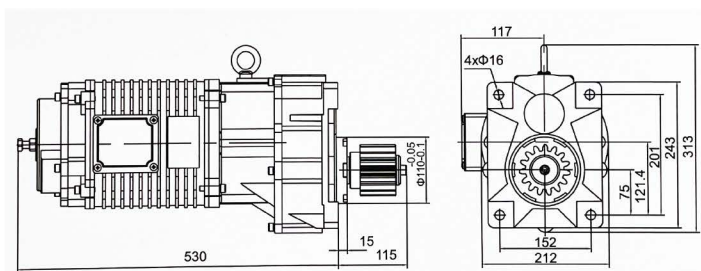

Model	Motor Output (kW x Pole)	Speed (50Hz)	Output Gear (Module x Teeth)
BM-300 (Ratio 16:1) 3P 380V	2.2kW x 4P	92 rpm	*
	1.5kW x 6P	61 rpm	*
	1.5/0.5kW x 4/12P	92/30 rpm	*

\*Can be changed upon request.  
Module: M3, M3.5, M4; Teeth: 10T, 12T, etc.

## Portable Gantry Crane - Model PRG



Model	Rated Load (kg)	Dimension (mm)											Net Weight (kg)	
		A	B	C	D	E	F	G	H	I	J	K		L
PRGS20	500	2,000	2 x 200	1,100 - 1,500	1,450 - 2,050	6 x 100	1,776 - 2,376	1,158	1,856 - 2,456	100	2,080	420	440	33
PRGS23	400	2,300	3 x 200	1,200 - 1,800							2,380			35
PRGS40	250	4,000	4 x 200	2,700 - 3,500							4,080			40
PRGM20	400	2,000	2 x 200	1,100 - 1,500	1,454 - 2,154	7 x 100	1,215	1,860 - 2,560	100	2,080	420	440	35	
PRGM23	400	2,300	3 x 200	1,200 - 1,800						2,380			36	
PRGM40	250	4,000	4 x 200	2,700 - 3,500						4,080			41	
PRGT20	250	2,000	2 x 200	1,100 - 1,500	1,928 - 2,928	10 x 100	2,254 - 3,254	1,586	2,334 - 3,334	100	2,645	420	440	39
PRGT23	250	2,300	3 x 200	1,200 - 1,800							2,380			40
PRGT40	250	4,000	4 x 200	2,700 - 3,500							4,080			45
PRG1S20	1,000	2,000	2 x 200	1,102 - 1,502	1,430 - 1,930	5 x 100	1,822 - 2,322	1,270	1,904 - 2,404	100	2,077	464	536	45
PRG1S30	1,000	3,000	3 x 200	1,902 - 2,502							3,077			53
PRG1S40	500	4,000	3 x 200	2,902 - 3,502							4,077			58
PRG1M20	1,000	2,000	2 x 200	1,102 - 1,502	1,740 - 2,440	7 x 100	2,061 - 2,761	1,484	2,143 - 2,843	100	2,200	464	536	49
PRG1M30	1,000	3,000	3 x 200	1,902 - 2,502							3,077			54
PRG1M40	500	4,000	3 x 200	2,902 - 3,502							4,077			59
PRG1T20	1,000	2,000	2 x 200	598 - 1,050	1,980 - 2,880	9 x 100	2,301 - 3,201	1,698	2,383 - 3,383	100	2,830	464	536	53
PRG1T30	1,000	3,000	3 x 200	1,417 - 2,017							3,077			58
PRG1T40	500	4,000	3 x 200	2,385 - 2,985							4,077			62

# Crane Wheel Block DRS Series

## European Crane Wheel Block - Model DRS

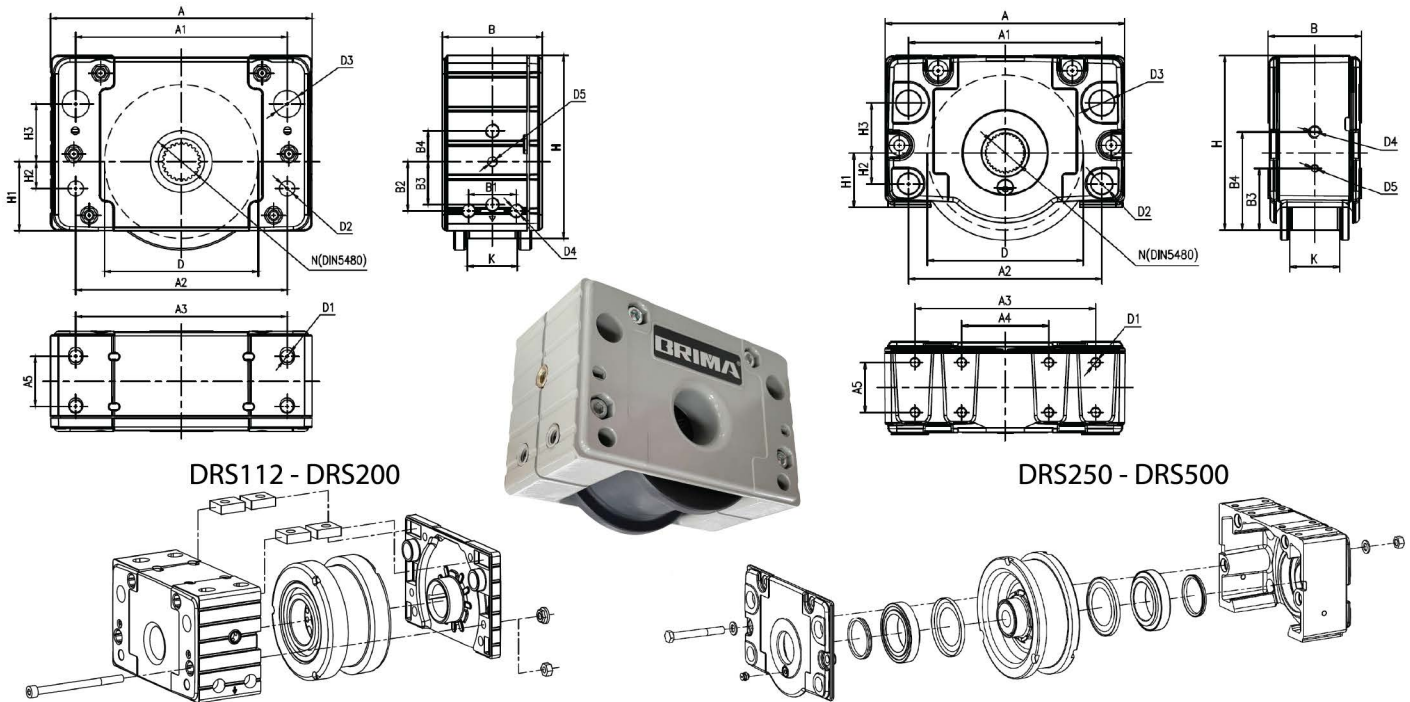

Model	Dimension (mm)													Max. Load (kN)
	D	A	B	H	K	H1	H2	H3	H4	B1	B2	B3	B4	
DRS112	112	190	96	131	60	47	30	40	80	40	30	-	24	27.5
DRS125	125	220	98	147.5	60	53.5	20	40	100	50	37	-	37.5	50
DRS160	160	275	110	187	65	70	25	55	100	54	47.5	-	20	70
DRS200	200	340	130	238	65	90	35	75	100	62	64	56	40	100
DRS250	250	385	150	281	75	89	50	80	-	-	-	100	-	160
DRS315	315	470	180	349.5	90	114	70	80	-	-	-	100	130	220
DRS400	400	580	210	440	100	144	95	130	-	-	-	100	130	300
DRS500	500	700	240	566	110	183	110	160	-	-	-	100	130	400

Model	Dimension (mm)											Net Weight (kg)
	A1	A2	A3	A4	A5	D1	D2	D3	D4	D5	N (DIN5480)	
DRS112	145	145	145	-	45	4 x M12	10.5	18.5	4 x M12	2 x M12	W30 x 1.25 x 30 <sup>0</sup> x 22 x 7H	10.0
DRS125	175	175	170	-	55	4 x M12	13	21	4 x M12	2 x M12	W30 x 1.25 x 30 <sup>0</sup> x 22 x 7H	15.0
DRS160	220	220	220	-	55	4 x M16	17	30	4 x M16	2 x M12	W45 x 2 x 30 <sup>0</sup> x 21 x 7H	26.0
DRS200	275	275	275	-	65	4 x M16	20	35	8 x M16	2 x M12	W50 x 2 x 30 <sup>0</sup> x 24 x 7H	41.0
DRS250	310	310	290	140	80	8 x M16	34	40	-	2 x M12	W65 x 2 x 30 <sup>0</sup> x 31 x 7H	70.0
DRS315	370	370	360	180	100	8 x M16	40	50	2 x M20	2 x M12	W65 x 2 x 30 <sup>0</sup> x 31 x 7H	130.0
DRS400	450	450	440	210	120	8 x M20	31	65	2 x M20	2 x M12	W90 x 3 x 30 <sup>0</sup> x 28 x 7H	220.0
DRS500	580	580	620	480	125	8 x M20	31	70	2 x M20	2 x M12	W90 x 3 x 30 <sup>0</sup> x 28 x 7H	380.0

## Explosion-proof Electric Chain Hoist - Model BMFB (2-direction)



Model	Rated Load (ton)	Load Chain		Lifting Speed (m/min)	Lifting Motor Output (kW)	Min. Headroom (mm)
		Dia. (mm)	No. of falls			
BMFB0101	1.0	7.1	1	6.6	1.5	650
BMFB01501	1.5	10.0	1	8.8	3.0	800
BMFB0201	2.0	10.0	1	6.6	3.0	800
BMFB02501	2.5	11.2	1	6.6	3.0	845
BMFB0301	3.0	11.2	1	5.4	1.5	845
BMFB0502	5.0	11.2	2	2.7	3.0	1,030
BMFB1004	10.0	11.2	4	2.7	2 x 3.0	1,400

## Explosion-proof Electric Chain Hoist - Model BMFB (4-direction)



Model	Rated Load (ton)	Load Chain		Lifting		Traversing		Beam Width (mm)	Min. Headroom (mm)
		Dia. (mm)	No. of falls	Speed (m/min)	Motor Output (kW)	Speed (m/min)	Motor Output (kW)		
BMFB0101	1.0	7.1	1	6.6	1.5	11 or 21	0.4	58 - 153	650
BMFB01501	1.5	10.0	1	8.8	3.0	11 or 21	0.4	82 - 178	770
BMFB0201	2.0	10.0	1	6.6	3.0	11 or 21	0.4	82 - 178	770
BMFB02501	2.5	11.2	1	6.6	3.0	11 or 21	0.75	100 - 178	830
BMFB0301	3.0	11.2	1	5.4	1.5	11 or 21	0.75	100 - 178	830
BMFB0502	5.0	11.2	2	2.7	3.0	11 or 21	0.75	100 - 178	1,015
BMFB07503	7.5	11.2	3	1.8	3.0	11 or 21	0.75	100 - 178	1,200
BMFB1004	10.0	11.2	4	2.7	2 x 3.0	11 or 21	2 x 0.75	150 - 220	1,190

## Low-headroom Ex-proof Electric Chain Hoist - Model BMFB (4-direction)

Model	Rated Load (ton)	Load Chain		Lifting		Traversing		Beam Width (mm)	Min. Headroom (mm)
		Dia. (mm)	No. of falls	Speed (m/min)	Motor Output (kW)	Speed (m/min)	Motor Output (kW)		
BMFB0101	1.0	7.1	1	6.6	1.5	11 or 21	0.4	58 - 153	480
BMFB01501	1.5	10.0	1	8.8	3.0	11 or 21	0.4	82 - 178	570
BMFB0202	2.0	7.1	2	3.3	1.5	11 or 21	0.4	82 - 178	535
BMFB02501	2.5	11.2	1	6.6	3.0	11 or 21	0.75	100 - 178	640
BMFB0301	3.0	11.2	1	5.4	1.5	11 or 21	0.75	100 - 178	640
BMFB0502	5.0	11.2	2	2.7	3.0	11 or 21	0.75	100 - 178	740
BMFB07503	7.5	11.2	3	1.8	3.0	11 or 21	0.75	100 - 178	890
BMFB1004	10.0	11.2	4	2.7	2 x 3.0	11 or 21	2 x 0.75	150 - 220	890

**Ex Mark :**

**Hoist - Ex db IIB T4 Gb / Ex tb IIIC T135°C IP65**  
**Trolley - Ex d IIC T4 Gb / Ex tD A21 T130°C IP65**